

PLAN VIEW

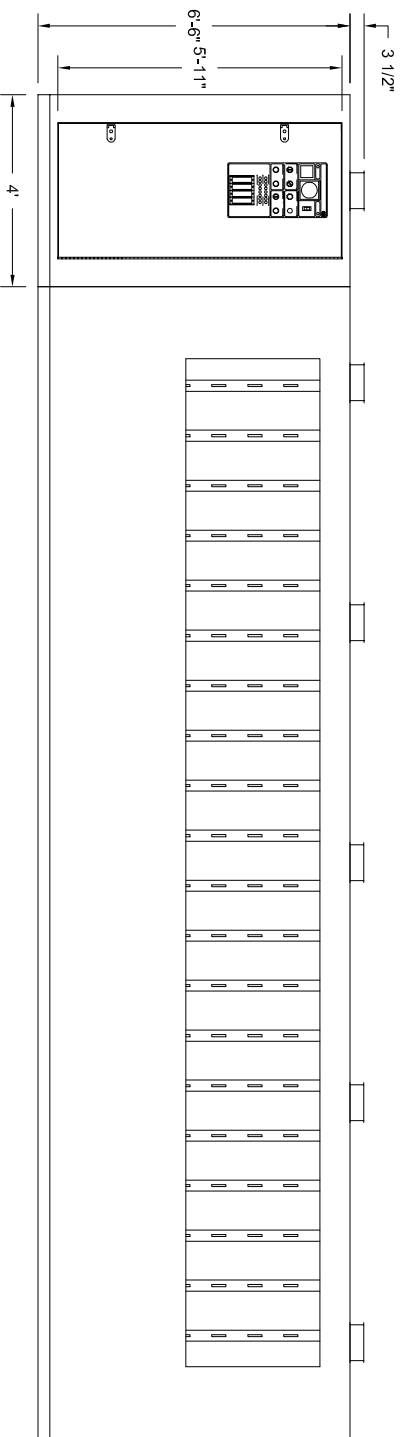

FRONT VIEW

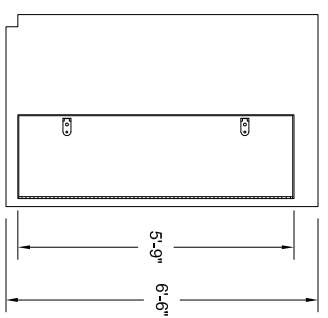

RIGHT END VIEW

POWER ENTRANCE: 240V, 70A, 60HZ, SINGLE PH. (TWO #6 + ONE #2 EARTH GND REQUIRED) (OTHER VOLTAGES AVAILABLE UPON REQUEST)

AIR INLET: 3/8" NPT (40PSI MIN., BULKHEAD PROVIDED) FILTER, REGULATOR, AND SHUT OFF PROVIDED ON SUBPANEL INSIDE PANEL ENCLOSURE.

NOTE: TESTER CAN BE SUPPLIED WITH OR WITHOUT POWER PANEL WHICH AND BE LOCATED AT EITHER END OF UNIT.

- REFERENCES AND REVISIONS -

REV.	DATE:	REMARKS:	BY:
A	7-19-1993	CHANGED POWER INPUT TO 1 1/2" CONDUIT WAS 3/4" CHANGED TO #2 EARTH GND, FROM #6 BLDG. GND	TRW

This drawing is proprietary information and considered intellectual property of Hanco International. Unauthorized reproducing, electronic transmission, or distribution without written authorization of Hanco International is prohibited.

HANCO INTERNATIONAL
 DIVISION OF THE HANNON COMPANY
 1605 WAYNESBURG DR. SE
 CANTON, OHIO, U.S.A. 44707
 PH: 330/456-4728 FAX: 330/456-3323

TITLE:
MODEL SST50621V SWITCH STICK TESTER
 DIMENSIONAL DRAWING

DATE: **2-27-1992** SCALE: **1/4" = 1'** SHEET: **1 OF 1**

DRAWN BY: **MRM** SERIES: **DA** DRAWING NO.: **A8687**