

NOTE 1: 240 VOLT, 60Hz, SINGLE PHASE POWER ENTRANCE. (TWO #6 PLUS ONE #2 EARTH GROUND IN 1 1/2" CONDUIT) OTHER VOLTAGE INPUTS AVAILABLE UPON REQUEST.

NOTE 2: 3/8" NPT AIR INLET (60 PSI MINIMUM, BULKHEAD FITTING PROVIDED) FILTER, REGULATOR, AND SHUT OFF PROVIDED ON SUBPANEL INSIDE POWER PANEL CABINET.

NOTE 3: 1/2" NPT WATER INLET (60 PSI MINIMUM) BULKHEAD FITTING PROVIDED

NOTE 4: THE FLOOR DRAIN MAY BE LOCATED ANYWHERE WITHIN 25 FEET OF THE TEST TANK BUT GENERALLY IS LOCATED WITHIN THE TEST COMPARTMENT. BE SURE TO SECURE THE END OF THE DRAIN LINE TO PREVENT WHIPPING.

30FT. 3/4" DRAIN HOSE PROVIDED WITH MACHINE TO BE RUN TO CUSTOMER FLOOR DRAIN

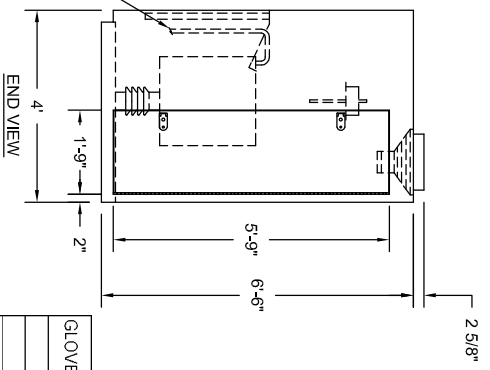

GLOVE POSITIONS	"A"	"B"	"C"	SHIPPING WEIGHT
2	8' - 7"	4' - 7"	2' - 3 1/2"	2540 LBS.
4	10' - 1"	6' - 1"	3' - 1/2"	2820 LBS.
6	11' - 7"	7' - 7"	3' - 9 1/2"	3158 LBS.
8	13' - 1"	9' - 1"	4' - 6 1/2"	3467 LBS.
10	14' - 7"	10' - 7"	5' - 3 1/2"	3760 LBS.
12	16' - 1"	12' - 1"	6' - 1/2"	4055 LBS.
14	17' - 7"	13' - 7"	6' - 9 1/2"	4380 LBS.

- REFERENCES AND REVISIONS -

REV.	DATE:	REMARKS:	BY:
A		CHANGED ACCESS DOOR TO TALL DOOR	TRW

This drawing is proprietary information and considered intellectual property of Hanco International. Unauthorized reproducing, electronic transmission, or distribution without written authorization of Hanco International is prohibited.

HANCO INTERNATIONAL
 DIVISION OF THE HANNON COMPANY
 1605 WAVERSBURG DR. SE
 CANTON, OHIO, U.S.A. 44707
 PH: 330/456-4728 FAX: 330/456-3323

TITLE: **MODEL "DA" GLOVE/ SLEEVE TESTER**
 DIMENSIONAL DRAWING
 LEFT HAND SYSTEM

DATE: **4-2-1996** SCALE: **1/4" = 1'** SHEET: **2 OF 2**
 DRAWN BY: **TERRY BAST** SERIES: **DA** DRAWING NO.: **A9025**